



## SPECIFICATIONS

**Mounting Frame** 16 gauge (.050") aluminum dieformed and welded construction, painted Sky White. See Finish Note.

**Reflector** Die formed 030" specular aluminum with 95% reflectance.

**Door Frame** 20 gauge (.036") C.R.S. gasketed with eight captive, countersunk fasteners, two safety wires attached to door, painted Sky White. See Finish Note.

**Ballast** SYLVANIA QUICKTRONIC® induction high frequency electronic ballast. Operating in a range 120-277V, 50/60Hz.

**Lamp** SYLVANIA ICETRON® from Osram Sylvania inductively coupled electrodeless fluorescent lamp with average rated life of 100,000 hours.

**Finish** All painted parts are washed in alkaline solution, rinsed in an iron phosphate, baked dry, then painted with a TGIC polyester powder coating electrostatic applied and baked. Standard color Sky White.

**Labels** ETL, CETL listed suitable for damp location. I.B.E.W. labeled. For wet location label, contact factory.

**Warranty** The mechanics are guaranteed to be free from defective material and workmanship, under normal installation and operating conditions, for five years from date of shipment from the factory. See general terms and conditions.

**Photometric Information** Contact factory or visit [www.escolighting.com](http://www.escolighting.com).

*SPECIFICATIONS SUBJECT TO CHANGE WITHOUT NOTICE*



Shown with four cell parabolic louver and prismatic glass lens.

## DIMENSIONS

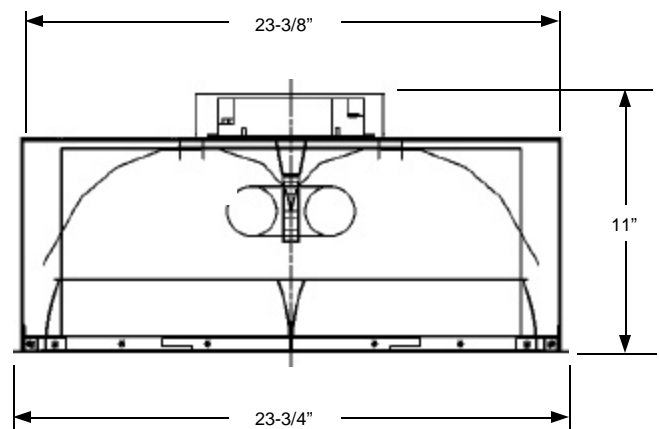

**WBE City of Chicago Certified**

3254 North Kilbourn Avenue Chicago, Illinois 60641-4505  
 Phone: 773-427-7000 Fax: 800-217-1260 [www.escolighting.com](http://www.escolighting.com)  
**Established 1975**





## HOW TO ORDER

### Prismatic Tempered Glass



Catalog Number	Lamps	Initial Lumens	Ballast	Color Temp
Ri10435	100W	8,600	ICE/100W	3500
Ri10441	100W	8,600	ICE/100W	4100
Ri10450	100W	8,300	ICE/100W	5000
Ri10535	100W	11,900	ICE/150W	3500
Ri10541	100W	11,900	ICE/150W	4100
Ri10550	100W	11,450	ICE/150W	5000
Ri10635	150W	13,000	ICE/150W	3500
Ri10641	150W	13,000	ICE/150W	4100
Ri10650	150W	12,700	ICE/150W	5000
Ri10735	200W	15,900	ICE/200W	3500
Ri10741	200W	15,900	ICE/200W	4100
Ri10750	200W	15,600	ICE/200W	5000

### 16 Cell Parabolic Louver with Prismatic Glass lens.



Catalog Number	Lamps	Initial Lumens	Ballast	Color Temp
Ri14435	100W	8,600	ICE/100W	3500
Ri14441	100W	8,600	ICE/100W	4100
Ri14450	100W	8,300	ICE/100W	5000
Ri14535	100W	11,900	ICE/150W	3500
Ri14541	100W	11,900	ICE/150W	4100
Ri14550	100W	11,450	ICE/150W	5000
Ri14635	150W	13,000	ICE/150W	3500
Ri14641	150W	13,000	ICE/150W	4100
Ri14650	150W	12,700	ICE/150W	5000
Ri14735	200W	15,900	ICE/200W	3500
Ri14741	200W	15,900	ICE/200W	4100
Ri14750	200W	15,600	ICE/200W	5000

### Regressed Prismatic Tempered Glass



Catalog Number	Lamps	Initial Lumens	Ballast	Color Temp
Ri11435	100W	8,600	ICE/100W	3500
Ri11441	100W	8,600	ICE/100W	4100
Ri11450	100W	8,300	ICE/100W	5000
Ri11535	100W	11,900	ICE/150W	3500
Ri11541	100W	11,900	ICE/150W	4100
Ri11550	100W	11,450	ICE/150W	5000
Ri11635	150W	13,000	ICE/150W	3500
Ri11641	150W	13,000	ICE/150W	4100
Ri11650	150W	12,700	ICE/150W	5000
Ri11735	200W	15,900	ICE/200W	3500
Ri11741	200W	15,900	ICE/200W	4100
Ri11750	200W	15,600	ICE/200W	5000

### 9 Cell Parabolic Louver with Prismatic Glass lens



Catalog Number	Lamps	Initial Lumens	Ballast	Color Temp
Ri16435	100W	8,600	ICE/100W	3500
Ri16441	100W	8,600	ICE/100W	4100
Ri16450	100W	8,300	ICE/100W	5000
Ri16535	100W	11,900	ICE/150W	3500
Ri16541	100W	11,900	ICE/150W	4100
Ri16550	100W	11,450	ICE/150W	5000
Ri16635	150W	13,000	ICE/150W	3500
Ri16641	150W	13,000	ICE/150W	4100
Ri16650	150W	12,700	ICE/150W	5000
Ri16735	200W	15,900	ICE/200W	3500
Ri16741	200W	15,900	ICE/200W	4100
Ri16750	200W	15,600	ICE/200W	5000

### Acrylic Prismatic Drop Lens



Catalog Number	Lamps	Initial Lumens	Ballast	Color Temp
Ri12435	100W	8,600	ICE/100W	3500
Ri12441	100W	8,600	ICE/100W	4100
Ri12450	100W	8,300	ICE/100W	5000
Ri12535	100W	11,900	ICE/150W	3500
Ri12541	100W	11,900	ICE/150W	4100
Ri12550	100W	11,450	ICE/150W	5000
Ri12635	150W	13,000	ICE/150W	3500
Ri12641	150W	13,000	ICE/150W	4100
Ri12650	150W	12,700	ICE/150W	5000
Ri12750	200W	15,900	ICE/200W	3500
Ri12750	200W	15,900	ICE/200W	4100
Ri12750	200W	15,600	ICE/200W	5000

### 4 Cell Parabolic Louver with Prismatic Glass lens



Catalog Number	Lamps	Initial Lumens	Ballast	Color Temp
Ri17435	100W	8,600	ICE/100W	3500
Ri17441	100W	8,600	ICE/100W	4100
Ri17450	100W	8,300	ICE/100W	5000
Ri17535	100W	11,900	ICE/150W	3500
Ri17541	100W	11,900	ICE/150W	4100
Ri17550	100W	11,450	ICE/150W	5000
Ri17635	150W	13,000	ICE/150W	3500
Ri17641	150W	13,000	ICE/150W	4100
Ri17650	150W	12,700	ICE/150W	5000
Ri17735	200W	15,900	ICE/200W	3500
Ri17741	200W	15,900	ICE/200W	4100
Ri17750	200W	15,600	ICE/200W	5000

**EXAMPLE ORDER: Ri11550=** 100 Watt lamp, 150 watt ballast, regressed prismatic tempered glass.

## OPTIONS AND ACCESSORIES

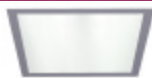

Stainless steel trim frame option.  
 Prefix catalog number with **RISV**



Wire guard option. Suffix catalog number with **WG01**



Tamper proof screw option  
 suffix catalog number with **TP**



### WBE City of Chicago Certified

3254 North Kilbourn Avenue Chicago, Illinois 60641-4505  
 Phone: 773-427-7000 Fax: 800-217-1260 [www.escolighting.com](http://www.escolighting.com)  
**Established 1975**

